

REVISIONS		
DATE	NAME	NO.
3-26-10	Michael J. Berry	21787
9-16-10	"	"
2-19-16	Stephen P. Eid	30081

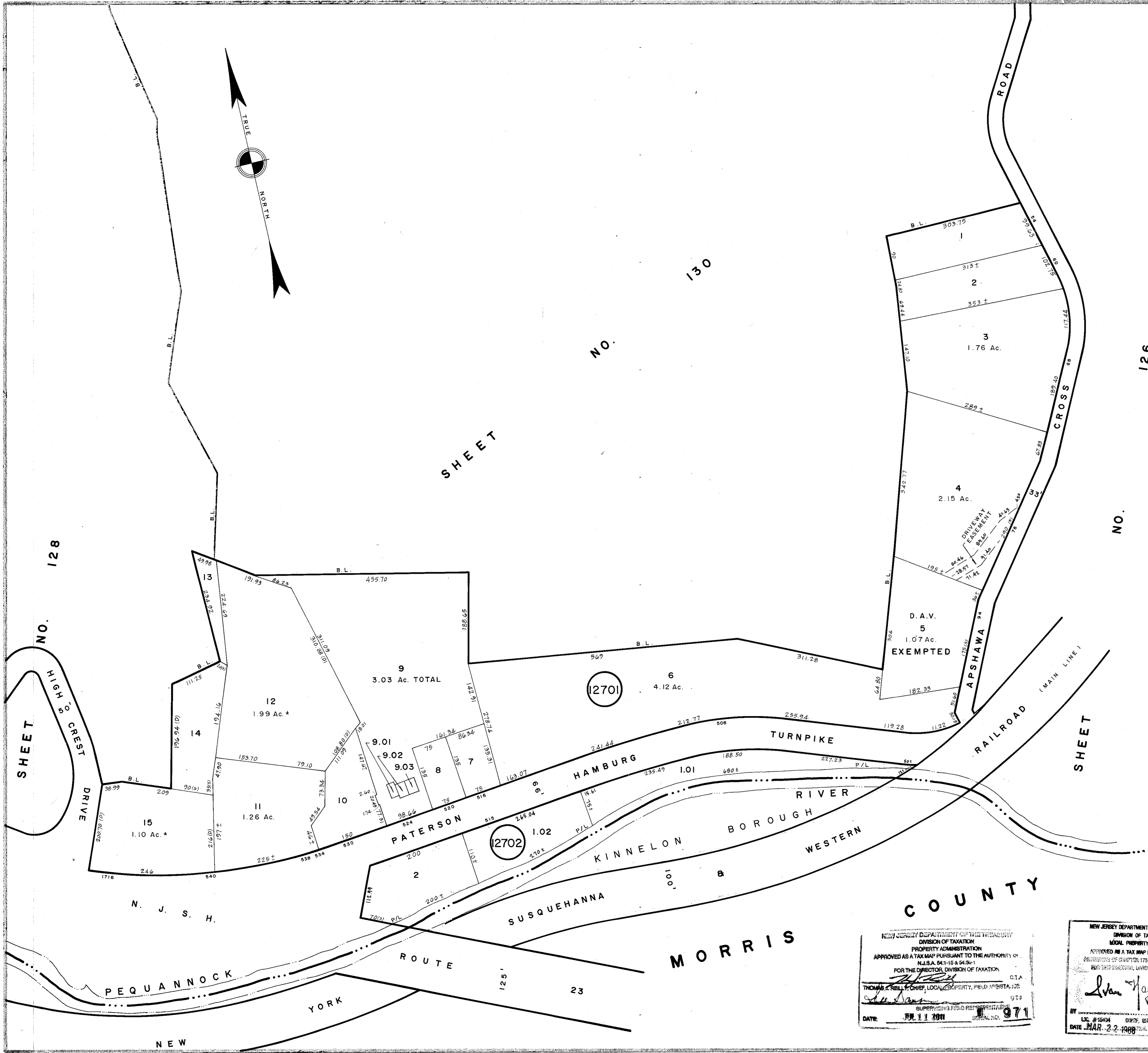

NEW JERSEY DEPARTMENT OF THE TREASURY  
 DIVISION OF TAXATION  
 PROPERTY ADMINISTRATION  
 APPROVED AS A TAX MAP PURSUANT TO THE AUTHORITY OF  
 N.J.S.A. 54:1-15 & 54:5-1  
 FOR THE DIRECTOR, DIVISION OF TAXATION  
 THOMAS J. BELL, CHIEF, LOCAL PROPERTY, FIELD REPRESENTATIVE  
 DATE: JUL 11 2011 SERIAL NO. 971

NEW JERSEY DEPARTMENT OF THE TREASURY  
 DIVISION OF TAXATION  
 LOCAL PROPERTY BRANCH  
 APPROVED AS A TAX MAP PURSUANT TO THE  
 PROVISIONS OF CHAPTER 175, LAWS OF 1918, ETC.  
 BY: [Signature]  
 DATE: MAR 22 1988 SERIAL NO. 680

**TAX MAP**  
**TOWNSHIP OF WEST MILFORD**  
 PASSAIC COUNTY, NEW JERSEY  
 SCALE: 1" = 100' DATE: 9-30-86  
**ANDREW J. LYCOSKY** P.E. & L.S.  
 TOWNSHIP ENGINEER  
 1480 UNION VALLEY ROAD  
 WEST MILFORD